

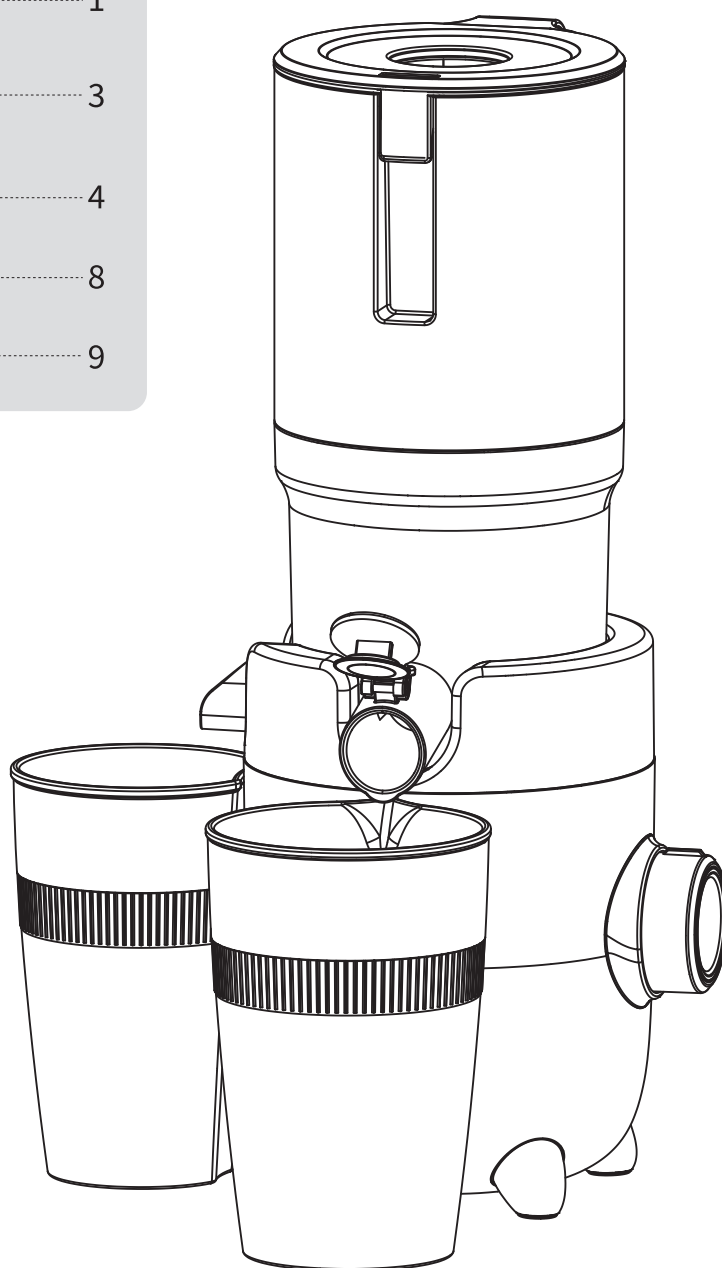

Cold Press Juicer

Safety Notice.....	1
Product Specifications and Component Names	3
Product Usage Guide.....	4
Safety and Maintenance Instructions.....	8
Common Failures and Solutions.....	9



Household use only.

For optimal performance, please read the user guide carefully before using your new appliance. We also recommend keeping the instructions for future reference to easily recall its functions.

Safety Notice

Important Safety Precautions

WARNING: When encountering similar signs, refer to the safety precautions to avoid potential injuries and damages.

1. This appliance is not intended for use by persons (including children) with reduced physical, sensory or mental capabilities, or lack of experience and knowledge, unless they have been given supervision or instruction concerning use of the appliance by a person responsible for their safety.
2. Children should be supervised to ensure that they do not play with the appliance.
3. If the supply cord is damaged, it must be replaced by the manufacturer, its service agent or similarly qualified persons in order to avoid a hazard.
4. Potential injury from misuse.
5. Care shall be taken when handling the sharp cutting blades, emptying the bowl and during cleaning.
6. Be careful if hot liquid is poured into the food processor or blender as it can be ejected out of the appliance due to a sudden steaming.
7. Do not use the appliance if the rotating sieve or the protecting cover is damaged or has visible cracks.
8. This appliance is intended to be used in household and similar applications such as:
 - Staff kitchen areas in shops, offices and other working environments;
 - Farm houses;
 - By clients in hotels, motels and other residential type environments;
 - Bed and breakfast type environments.
9. Ginger & Celery which has high fiber content, needs to be cut into 3cm small sections to avoid slow or clogged residue, which may affect product use. The maximum continuous working time is 10 minutes.
10. This appliance shall not be used by children. Keep the appliance and its cord out of reach of children.
11. Switch off the appliance and disconnect from supply before changing accessories or approaching parts that move in use.

CAUTION! Please read the following recommendations for the correct and safe use of your juicer to avoid electrical shorts and fires.

12. It is strictly forbidden to touch screws, motors, and other moving parts with hands during work to prevent personal injury accidents.
13. This product operates on AC voltage. Before connecting to the power supply, please ensure that the voltage matches the product to avoid damaging it.
14. When the product is in operation, it is strictly prohibited to bring eyes close to the feeding port to prevent accidents and injuries.
15. Before turning on the power, please make sure that the removable components are properly installed and do not operate the product without load.
16. It is recommended to stop using the product after continuous operation for 10 minutes. At this time, please turn off the machine for 30-45 minutes to allow the motor to cool down before using it again to ensure product lifespan.
17. If the ingredients are too much or too hard, causing blockage, please turn the knob to the reverse gear, reverse for a few seconds, and then continue to use. If the problem persists, disconnect the power, clean the ingredients, and then use it again.
18. After processing is complete, please turn off the switch, disconnect the power, and wait for the motor and screw to stop rotating before removing the removable components.

19. The size of the ingredients should be suitable for the feeding port. When juicing, use the pusher to slowly and evenly push and compress the ingredients. Do not apply excessive force. For hard-textured ingredients like lotus root, cut them into pieces no larger than 2cm.
20. Before powering on the product and adding ingredients, if there is a slight abnormal sound from the feeding tube when the screw is rotating, it may indicate that the screw is not installed properly. Please turn off the switch, disconnect the power, and push the screw to the bottom in the direction of the main body before juicing.
21. Remove the pits, hard seeds, and thick peels or shells from ingredients such as peaches, plums, apricots, cherries, mangoes, grapes, persimmons, oranges, tangerines, and pomelos before using to avoid damaging the product.
22. Lemon contains highly acidic juice. Do not exceed 20g (approximately 3 slices) per juicing.
23. The parts that come into contact with ingredients are made of materials that meet food-grade certification requirements, which are clean, hygienic, and reliable. After juicing certain ingredients, the parts may be stained, which is a normal phenomenon and does not affect their use.
24. This product strictly prohibits processing overheated ingredients ($\geq 60^{\circ}\text{C}$ (140°F)) to prevent component breakage and splashing burns.
25. Please operate this product on a level platform and avoid using it on tilted or unstable surfaces, carpets, towels, flammable materials like plastics and paper, and stay away from the edges of the table to prevent accidents.
26. It is strictly prohibited to insert hands, chopsticks, or any other objects into the feeding port or juice outlet.
27. The use of this product to juice sugarcane is prohibited.
28. Do not immerse the main body of the product in water or other liquids for cleaning.
29. Do not plug or unplug the power plug with wet hands to avoid electric shock.

Daily Operation Guidelines

30. This product is for household use only. Please follow the instructions in this manual.
31. The operating speed of this product has been set to the optimal state and does not require speed adjustment.
32. Do not place this product in high-temperature environments, strong magnetic fields, flammable or explosive gases (such as natural gas, biogas, etc.) to prevent abnormal operation or accidents.
33. Before use, please check if the juicing body, screw, and other accessories are damaged. If any damage is found, please stop using it. If the product needs to be repaired, please contact our customer service department or go to our designated repair center for repair. Do not disassemble, repair, or modify it yourself to avoid risks.
34. Do not clean or disinfect the plastic parts of this product in a sterilizer, dishwasher, or hot water above 60°C (140°F) to avoid deformation and damage due to heat.
35. When the product is not in use, please turn off the switch and disconnect the power to prevent damage caused by short circuits or other accidents.
36. Do not use parts other than those provided with the product to avoid affecting its performance or causing accidents.
37. This product is only intended to be used with matching components (including those included with the product and independently sold by our company), such as the feeding tube and juicing components. Do not use non-matching parts to avoid affecting the product's performance or causing accidents.
38. Be careful when disassembling, cleaning, and washing removable components to avoid injury or damage to the accessories.

Please keep these instructions and your purchase receipt to ensure your legal rights.

Product Specifications and Component Names

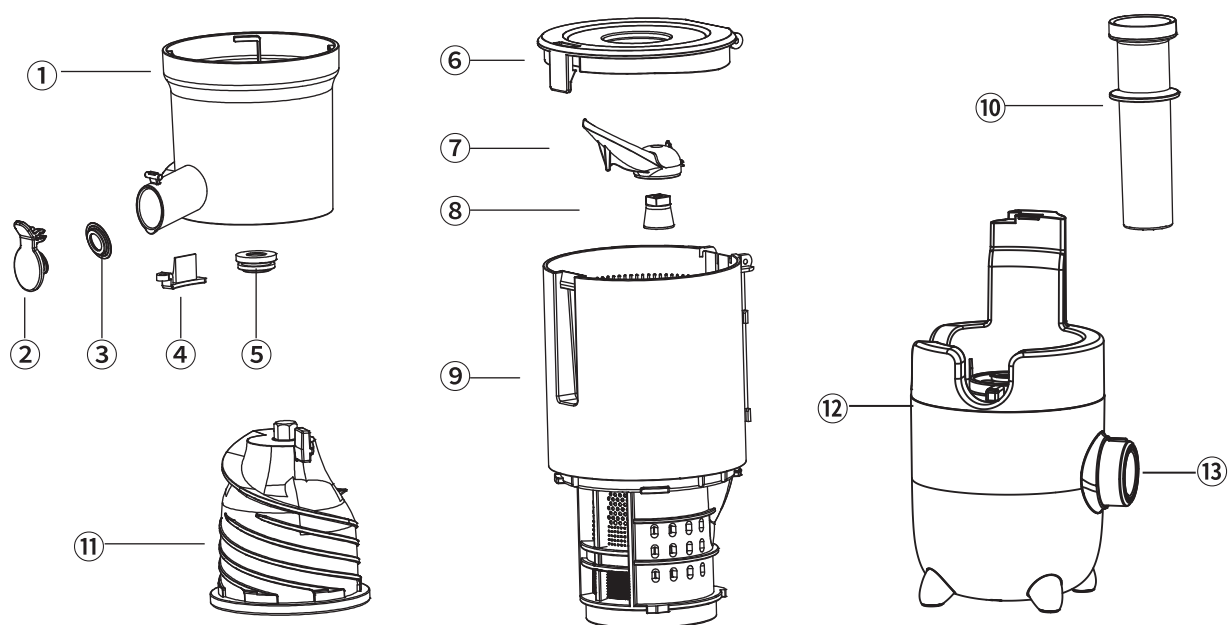

- ① Large Cup
- ② Juice Blocking Lid
- ③④⑤ Sealing Ring
- ⑥ Feed Cover
- ⑦ Smashing Knife
- ⑧ Connector
- ⑨ Juice Extraction Body
- ⑩ Pusher
- ⑪ Auger
- ⑫ Main Body
- ⑬ Power Switch

Product Model	ZM1905B
Rated Voltage	120V ~ 60Hz
Rated Power	200W
Dimensions	8.27x6.14x16.38 inch
Weight	101.59 oz

Product Usage Guide

WARNING: Ensure that the connected power supply is suitable for this machine, otherwise it may damage the machine.

Installation

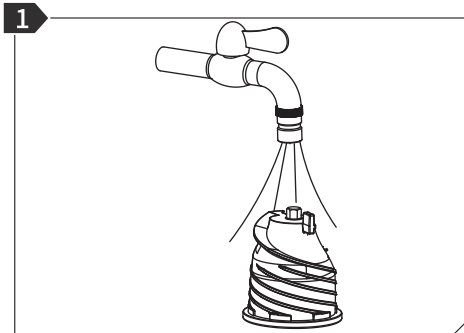

To guarantee optimal performance and hygiene, it's crucial to thoroughly clean each component of the product before initial use. Focus particularly on the auger and large cup, as well as any other accessible accessories. This will not only extend the lifespan of your appliance but also ensure that it operates at peak efficiency from the very first use.

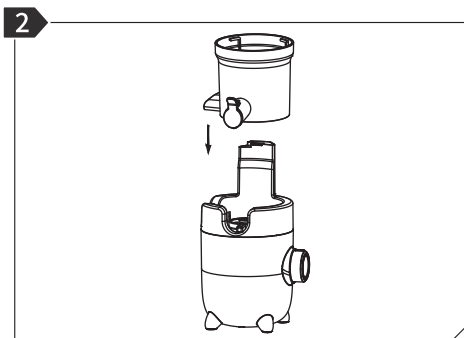

Carefully align the large cup with the designated slot on the main unit, following the detailed instructions provided in the diagram. This precise alignment ensures that the cup fits securely, enabling the unit to function efficiently and safely. Please refer to the diagram for clear visual guidance on how to properly install the cup into the main unit.

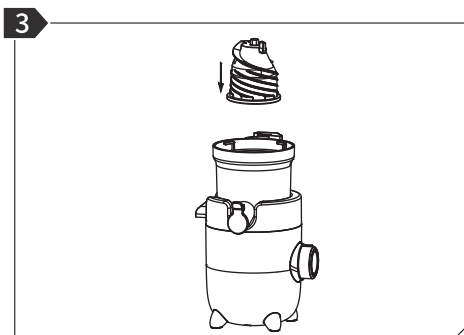

Insert the auger into the large cup, carefully following the direction indicated in the manual to ensure correct placement. It is essential that the auger is properly positioned as this is critical for the subsequent installation of the juice extraction body. Misalignment may prevent the assembly of other components and hinder the juicer's overall performance. Please double-check that the auger is securely and accurately installed before proceeding to the next step.

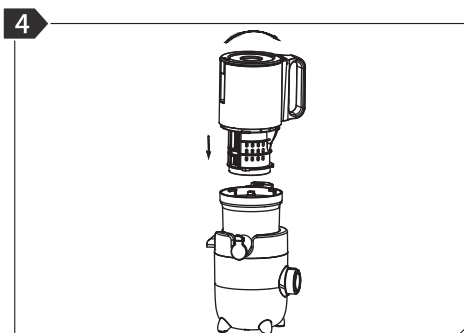

Carefully position the juice extraction body on top of the large cup, ensuring it aligns with the markings as indicated. Once aligned, gently rotate the extraction body clockwise until it clicks into place, securing it firmly on the large cup. This step is crucial for the stability and functionality of the appliance, as a properly installed extraction body ensures efficient juice processing and safety during operation. Ensure that the rotation is complete and the body is tightly fastened to prevent any operational issues.

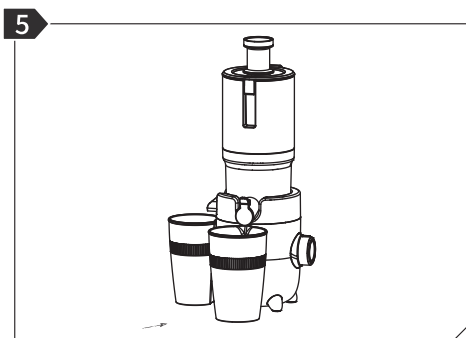

Once the juice extraction body is securely installed, proceed by positioning the juice cup and pulp container beneath their respective outlets. It's important to ensure that each container is properly aligned with the outlets to catch all the juice and pulp efficiently. This setup not only facilitates a smooth juicing process but also minimizes mess, making clean-up easier. Double-check that the containers are stable and correctly placed to optimize the performance of your juicing session.

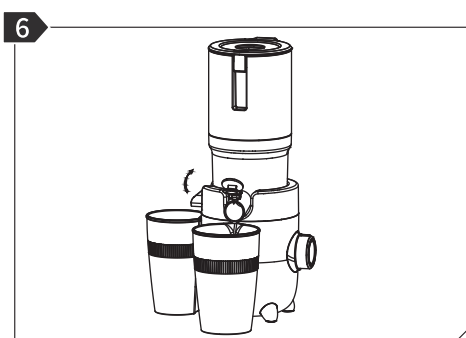

Lift the juice-blocking lid upwards as illustrated in the diagram provided. Make sure to follow the visual guide closely to ensure correct positioning. This action allows for proper flow and handling of the juice during operation, optimizing the appliance's efficiency and preventing spills. Ensure the lid is securely flipped to maintain the intended functionality throughout the juicing process.

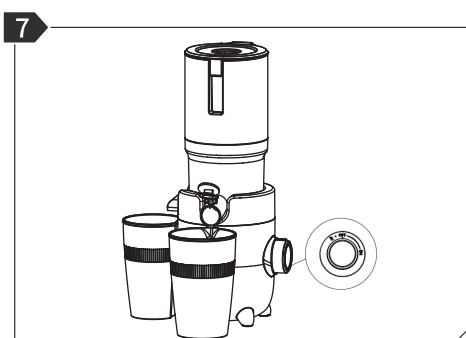

Attach the power cord from the main unit to a suitable power socket, ensuring a secure connection. Next, locate the knob switch on the main unit and turn it to the "ON" position. This action will activate the machine, allowing it to start its operation. With the juicer now powered and ready, you can begin the process of extracting fresh, nutritious juice from your chosen fruits and vegetables. Enjoy crafting a variety of delicious, healthy beverages with ease.

Usage

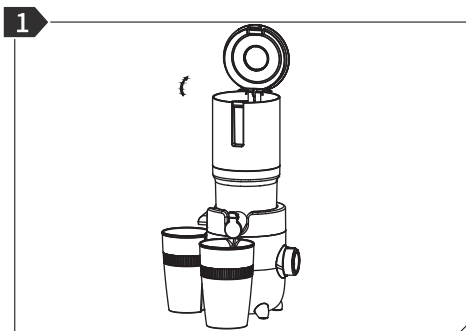

During the juicing process, you have the convenience of opening the feed chute cover by flipping it upward, as demonstrated in the diagram. This feature is designed to facilitate the insertion of medium-sized fruits or tomatoes directly into the large feed chute. The advantage here is that you can process these items whole, without the preliminary step of cutting them, making your juicing experience quicker and more efficient. This functionality enhances the ease of use and allows for continuous juicing, saving you time and effort.

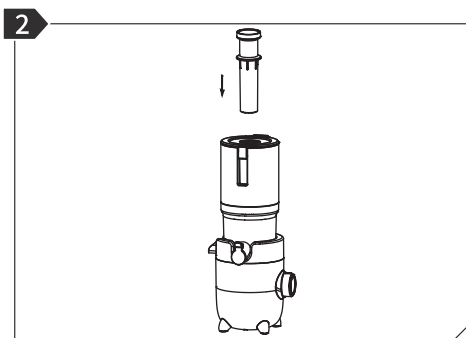

If you notice fruit chunks or pulp accumulating in the juice extraction body while juicing, it's important to address this to maintain optimal performance. Use the pusher provided with your juicer to gently guide these pieces down into the machine. This technique helps to ensure that all fruit material is efficiently processed, maximizing juice yield and preventing potential clogs or disruptions in the juicing process. Applying gentle pressure with the pusher facilitates smoother operation and more effective juice extraction.

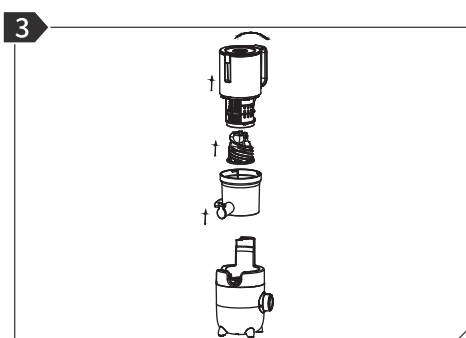

To detach the large cup assembly from the main unit, follow the instructions shown in the provided diagram. Carefully grasp the assembly and apply a gentle but firm pulling motion to separate it from the main body of the unit. This step is crucial for disassembling your machine, whether for cleaning, maintenance, or storage purposes. Ensure that you handle the components with care to avoid any damage and to maintain the functionality of your juicer for future use.

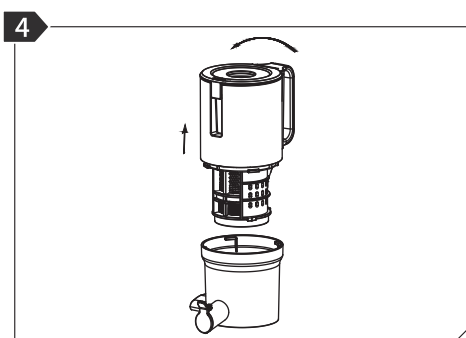

To remove the juice extraction body from the large cup, begin by rotating it counterclockwise. Make sure to grasp the body firmly and turn it gently to unlock it from its position. Once it is loosened, carefully lift it upward and away from the large cup. This method ensures that the component is removed safely without causing any strain or damage to the juicer. It is important for cleaning or when you need to replace or inspect the extraction body for any reason.

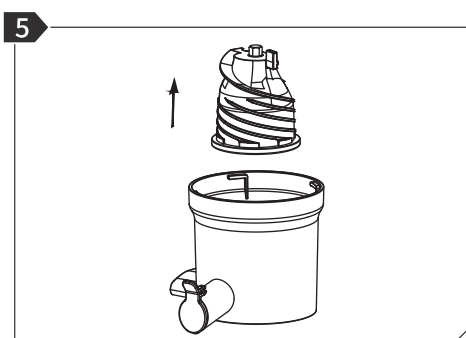

To remove the auger from the large cup, refer to the step-by-step visual instructions provided in the diagram. Gently grip the auger and lift it directly upward, carefully extracting it from the large cup. This procedure is essential for thorough cleaning or maintenance of the juicer. Ensuring that the auger is removed correctly helps to avoid any damage to the delicate components, maintaining the efficiency and longevity of your appliance.

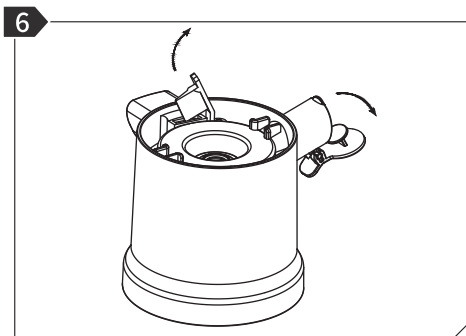

Due to potential accumulation of fruit pulp in the outlet of the large cup, it is advisable to open the silicone pulp guard along with the juice-blocking lid to facilitate thorough cleaning. This ensures that all pulp residues are completely removed, maintaining the cleanliness and functionality of your juicer. After cleaning, it is crucial to correctly reinstall the silicone pulp guard. This step is essential to ensure that during subsequent juicing sessions, the juice is directed properly through the juice outlet and does not escape through the pulp outlet, thereby optimizing the juicing process and preventing messes.

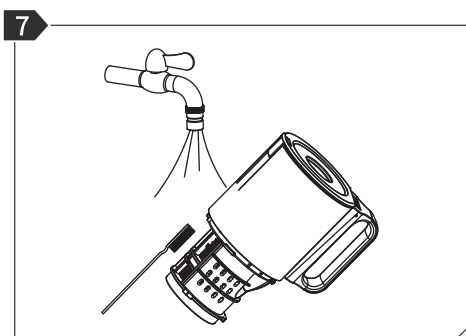

After disassembling the juicer, proceed to clean all the parts thoroughly as indicated in the provided diagram. Utilize a cleaning brush to meticulously scrub away any fruit pulp clinging to the metal filter within the juice extraction body. This step is crucial for preventing clogs and maintaining optimal performance of your juicer. Once the components are clean, arrange them in a clean, well-ventilated area to ensure they dry completely and evenly. Proper drying helps to prevent any mold or odor from developing. After all parts are dry, reassemble them or store them neatly to keep them organized and ready for your next juicing session. This careful maintenance routine extends the life of your juicer and ensures it remains ready for efficient use.

WARRANTY

Register One (1) Year Limited Warranty

This One (1) Year Limited Warranty applies to purchases made from authorized retailers of Rosewill Inc. ("Rosewill") by the original appliance owner and is not transferable. Please visit www.rosewill.com to register your new Rosewill appliance. Failure to register your product will not diminish your warranty rights. You will be asked to provide the store name, date of purchase, model number (found on the back of your appliance) and serial number (found on the bottom of your appliance) along with your name and email address.

Warranty Service

To obtain warranty service, please contact our Consumer Care Department by email to techsupport@rosewill.com or call to 1-800-575-9885. We will try to contact you as soon as possible. If we are unable to resolve the problem, you may be asked to send your appliance to the Service Department for quality inspection. Rosewill is not responsible for shipping costs related to warranty service. When returning your appliance, please include your name, mailing address, email address, phone number, and proof of the original purchase date as well as a description of the problem you are encountering with the appliance.

Safety and Maintenance Instructions



Power Management

After use, promptly disconnect the power by unplugging the power cord. This is crucial for safety and helps in preventing any electrical issues.



Water Exposure

Ensure that the main unit and power cord are never submerged in water to avoid electrical hazards and damage to the unit.



Surface Cleaning

For cleaning the surface of the main unit, use a damp cloth. Avoid abrasive materials like steel wool or hard brushes which can scratch or damage the surface.



Cleaning Detachable Parts

When washing the large cup and other removable components, avoid using hot water that exceeds 60°C (140°F). Instead, soak them in warm water mixed with a specified cleaning solution for about 5 minutes, followed by rinsing with clean water. After drying, reassemble the parts for future use.



Dishwasher Safe

You can clean detachable parts in a dishwasher, provided that the temperature setting does not exceed 60°C(140°F).



Operational Guidelines

To prevent overheating and to ensure the longevity of the machine, it is recommended not to operate the device continuously for more than 10 minutes at a time.

Following these guidelines will help maintain your appliance's efficiency and safety, ensuring it serves you well for many years.

Common Failures and Solutions

Problem	Cause Analysis	Troubleshooting
No reaction when the product is connected to the power supply	<ul style="list-style-type: none"> • Power cord is not inserted in place • Juice body is not installed in place • Continuous work time is too long, the host of the power failure protection 	<ul style="list-style-type: none"> • Plug the power cord into place • Reinstall the juicing body in place • Stop for 30-45 minutes before using again
The motor emits a strange odor	Normal phenomenon of new motor initial use	If there is still an odor after repeated use, please send it back to the maintenance point for testing.
Juice body won't fasten	Auger Not in place	Install the Auger in place according to the installation instructions
Downtime during use	<ul style="list-style-type: none"> • Adding too much food, overload or blocking the rotation caused by the shutdown • Continuous work time is too long, the mainframe power failure protection 	<ul style="list-style-type: none"> • Reduce putting food, twist the knob to Rev gear, let the screw and crumbs loose • Stop for 30-45 minutes and then use again
High noise level	Auger or juice body not in place, rubbing during operation	Reinstall in place according to installation instructions





Appliances need to be disposed of separately for scrap. Throwing them directly into the garbage is prohibited.



Explore more at *Rosewill*.

Technical Support Information

 techsupport@rosewill.com  1-800-575-9885  www.rosewill.com

Thank you for purchasing a quality Rosewill product.

Please register your product at www.rosewill.com for complete warranty information and support for your product.